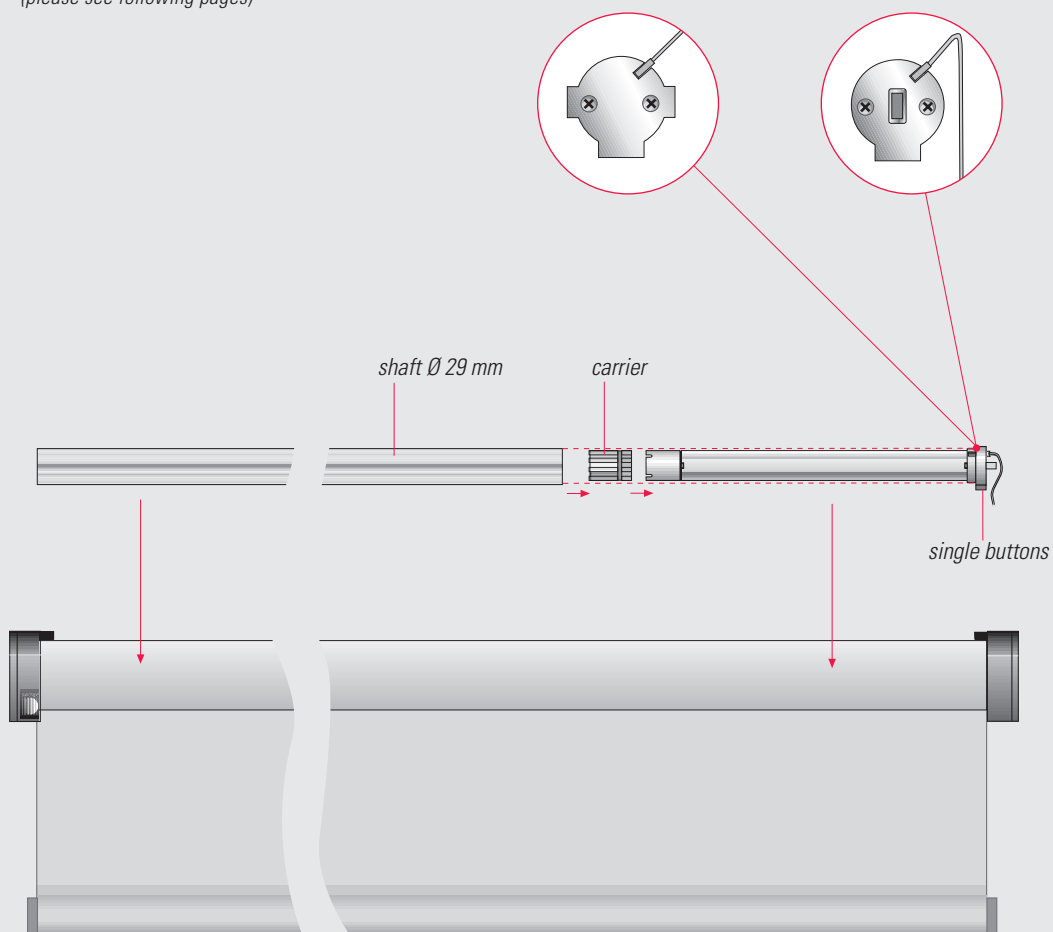

M**Motors**

- compact plug in drives in aluminium tube
- 29 mm diametre
- quick mounting
- easy end postion fixing
- low voltage; hence not dangerous connection
- integrated overload release, protecting motor and blind
- substantial control and operation elements (please see following pages)

endshield for roller blind with head box

with motor pilot for roller blind without head box

**Technical details**

nominal voltage	4 V DC
rated load torque	0,7 Nm*
nominal speed	34 rpm.
max. drapery weight	4 kg
cable length	2 m
stop switch capacity	40 revolutuions
mode of protection	IP 44

* descending according to increasing winding diameter

Advice: Substantial control and operation elements please see page M 22.

Attention: Electrical installations must be done through authorized personal!

Direct voltage drives: Blinds placed next to each other do not move exactly synchronous!



Fixing end position

Press both fixing buttons until stop and adjust. Connect motor via switch to power unit or to the motor control device. Should the requested up and down direction not correspond to switch position, please change poles.

Operation is that easy:

Direction signs are assigned to the fixing buttons.

1. press and adjust fixing button
2. move drapery exactly into the desired end position
3. press and re-adjust fixing button
4. fix end position

Up direction:

1. adjust fixing button by regarding the direction signs
2. move drapery into the requested upper position
3. press fixing button again and re-adjust it
4. the upper end position has now been fixed

Down direction:

1. move drapery into the requested lower position
2. press fixing button again and re-adjust it
3. the lower end position has now been fixed

Change an existing end position:

1. move drapery into the middle
2. adjust fixing button by regarding the direction signs
3. press corresponding fixing button and adjust it
4. move drapery into the new position
5. press and re-adjust fixing button
6. the new end position has now been fixed

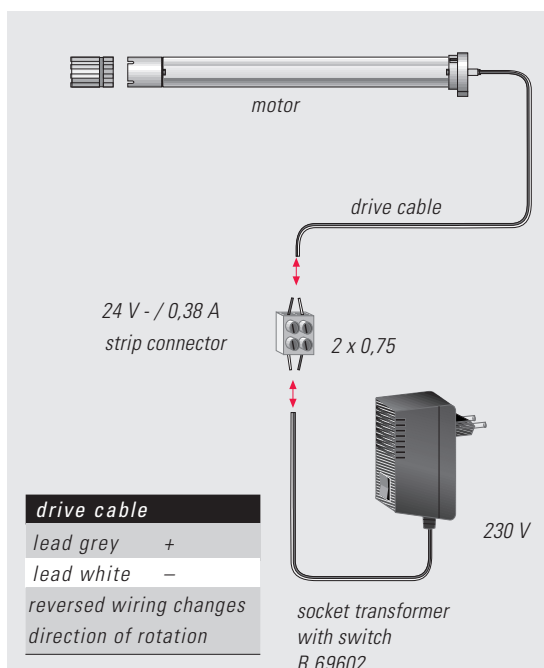
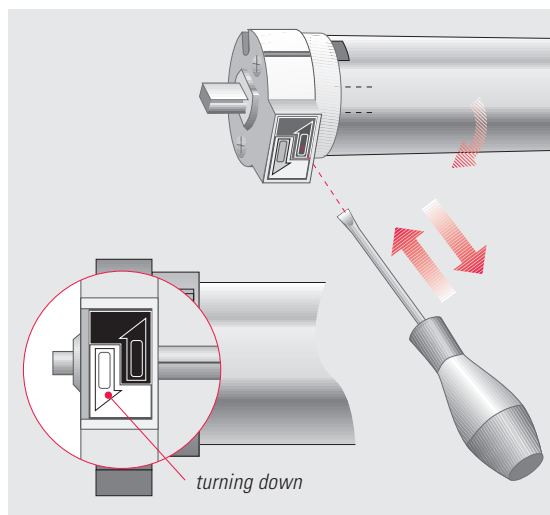
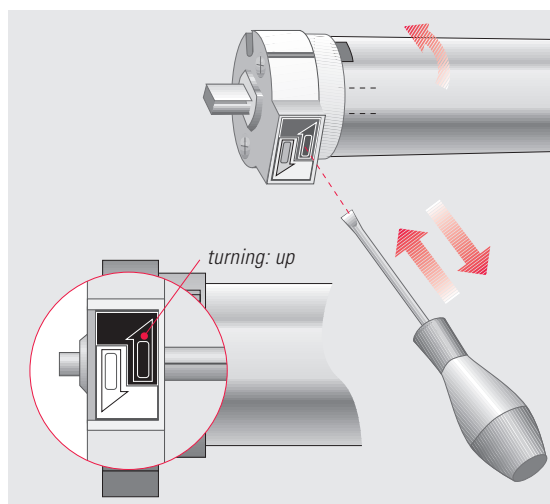
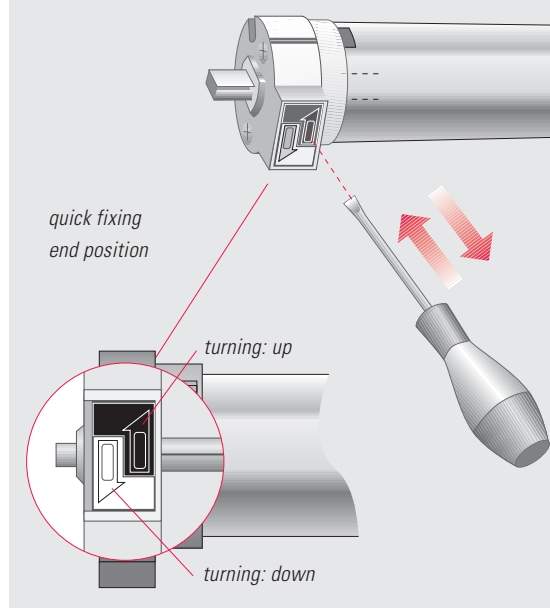



Single roller blind

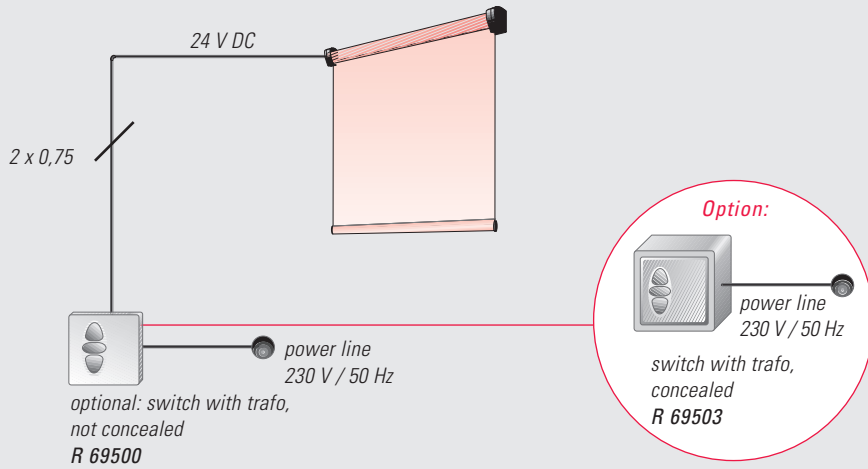

Single, group- and central control

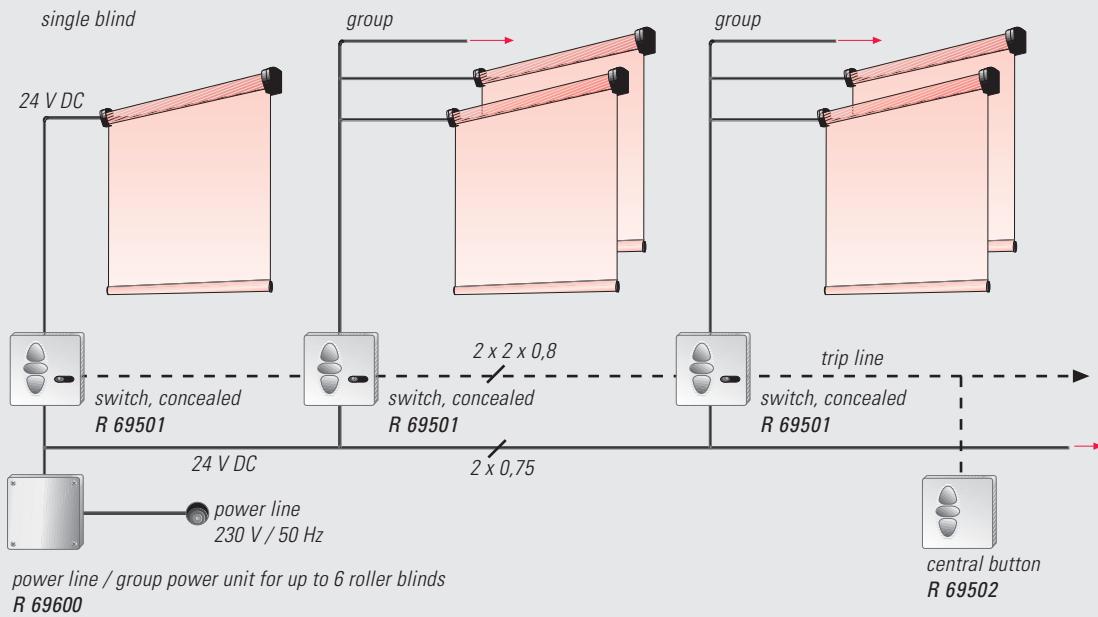

Radio control for single roller blinds

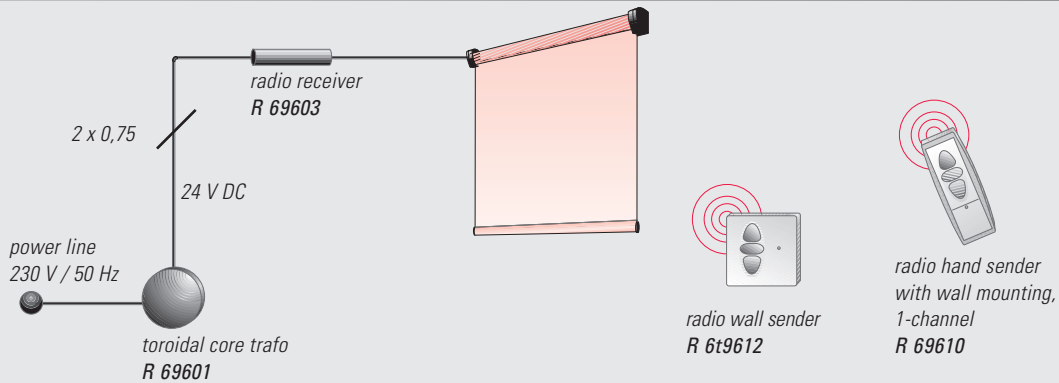

Attention: All order numbers are for switches without cover frame, not concealed; concealed mounting in switch box Ø 60 mm!



Single, group and central control

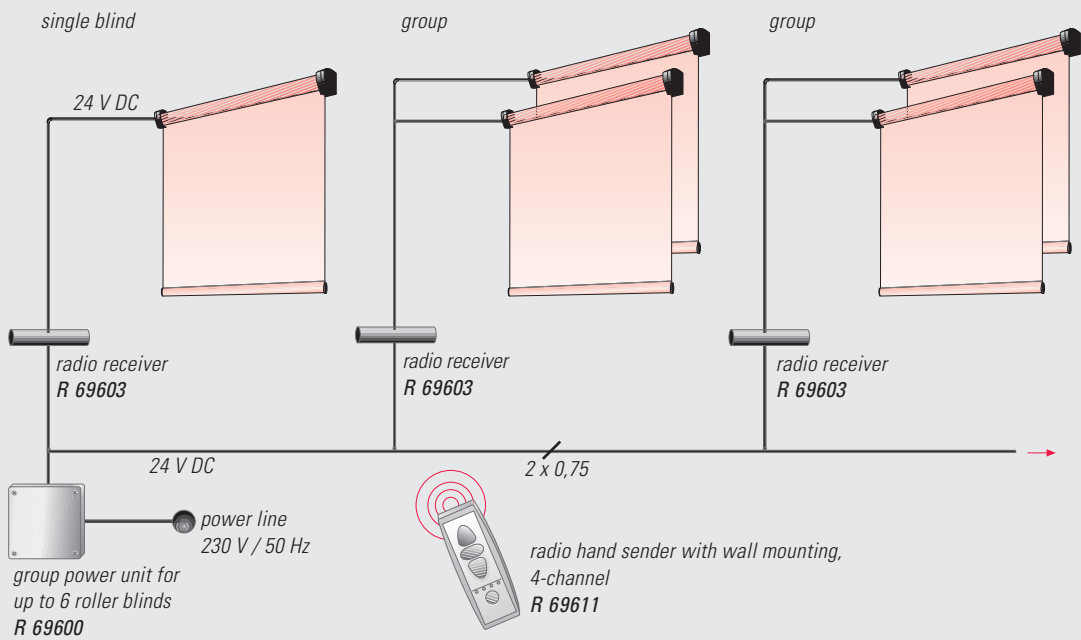

Single radio remote control/outlet box connection

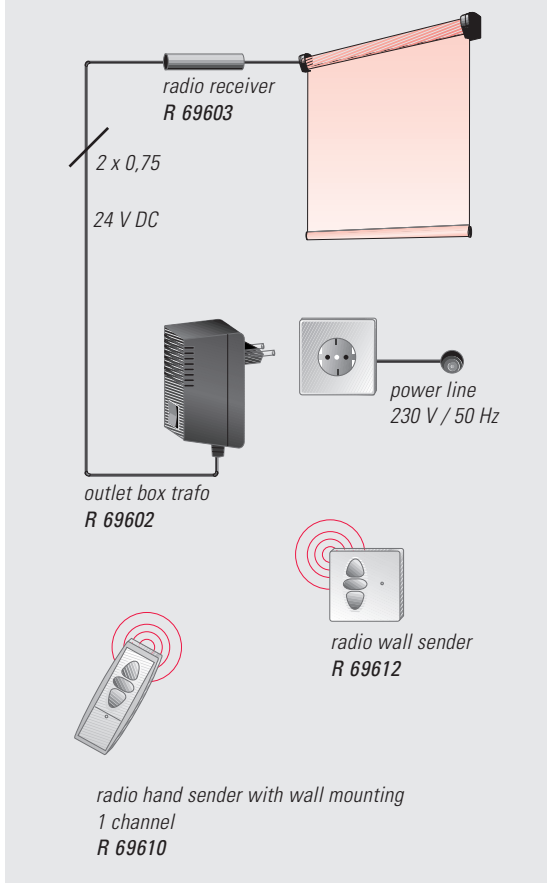

Group radio remote control

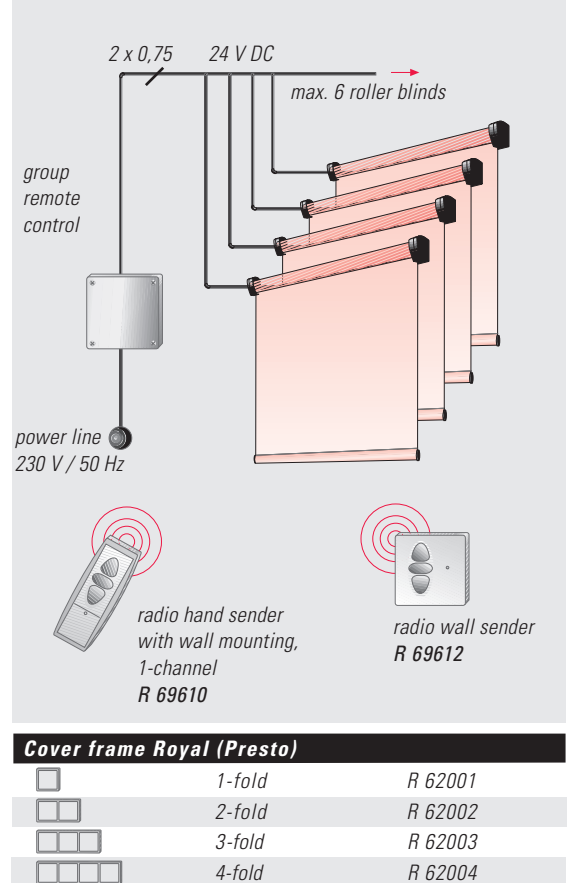

Cover frame Royal (Presto)

	1-fold	R 62001
	2-fold	R 62002
	3-fold	R 62003
	4-fold	R 62004

Attention: All order numbers are for switches without cover frame, not concealed; concealed mounting in switch box Ø 60 mm!

Safety instructions

Before starting sundrape® electric motors, group controls and radio remote controls carefully read technical instructions for connexion, mounting and operation.

In case of damages caused by disregarding these instructions, the guarantee expires. For consequential damages we do not assume any responsibility.

Attention – to assure the security of persons and facilities these instructions have to be observed absolutely! File the instructions carefully! This device is not designed for employees (including kids) with limited physical or mental skills or sensory perception or for persons with a lack of experience or knowledge, unless they are supervised by a person who is responsible for their security or unless they received instructions how to use the device.

Children are not allowed to play with stationary controls and electrical systems. Keep radio remote control devices away from children! Kids should be watched to make sure that they do not play with the device.

The system has to be checked regularly on signs of wear or damaged electrical lines.

Attention – inadequate mounting can cause severe injuries!

Before you start maintenance work on electrical blinds, always cut off power supply. The same applies to window cleaning work, if contact of humidity and cleaning agents with the electrical systems is possible.

Connexion instructions for sundrape® electric motors

Connexions and supply lines have to be passed on site by authorized electricians according to VDE (German Electrical Engineering Association) and local EVU (electric supply company) instructions. For controls of two and more motors a group control is required. Cable laying plans and wiring diagrams for group and central controls as well as remote controls can be submitted on request. Switch off unused lines and systems before you connect the motor. Place push-buttons above a height of 1,5 m near the system. Allowed running periods and torques have to correspond with the motor's technical data.

In order to avoid backing ups of condensers of running motors, parallel connexion of two or more motors at one exit is prohibited. For decoupling purposes a separate contact for each direction of rotation is required. Use only mechanically or electrically locked switches and push-buttons. Switches and controls may not permit concurrent up and down operation! The time to change the running direction from up/down to down/up has to be at a minimum of 0,5 seconds. This applies also for programmable control devices.